

Specialty Applications for Keystone Walls

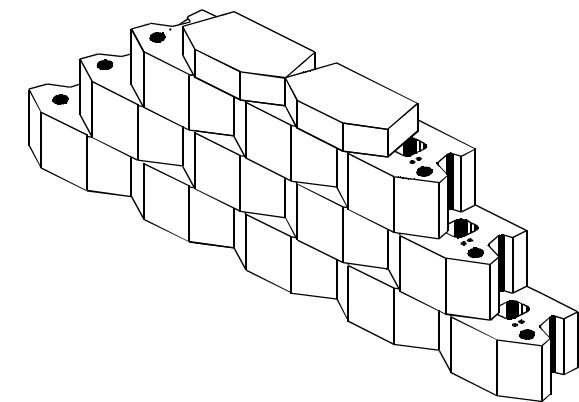

SHEET INDEX

Title Sheet	Sheet 1
Soil Nail Facing	Sheet 2
Rock/Shotcrete Facing	Sheet 3
Manta Ray Anchor Wall	Sheet 4
H-Pile Wall Facing	Sheet 5
Sheet Pile Wall Facing	Sheet 6
Concrete Wall Stairway	Sheet 7
Interlocking Gravity Wall	Sheet 8
Geofoam Wall Construction	Sheet 9
Foundation Obstruction	Sheet 10
Slip Joint Installation	Sheet 11
In-situ Slip Joint	Sheet 12

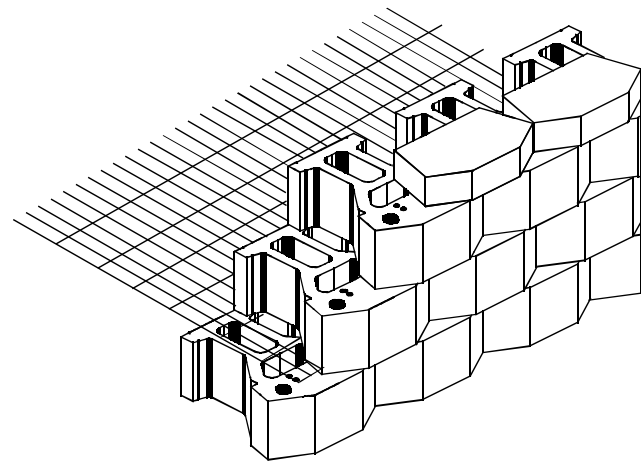
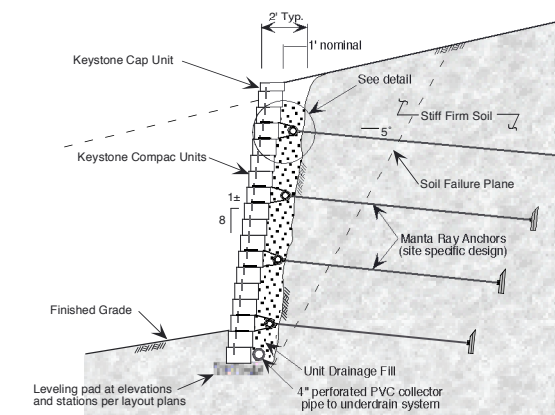
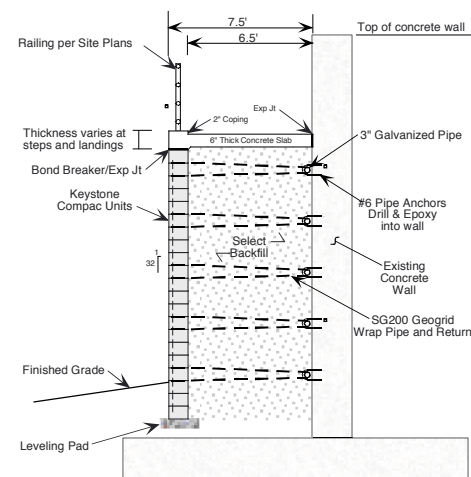

COPYRIGHT (c) 2000 by Keystone Retaining Wall Systems, Inc.

The information contained herein has been compiled by Keystone Retaining Wall Systems and to the best of our knowledge, accurately represents the Keystone product use in the applications which are illustrated. This drawing is being furnished for design guidance and estimating only. Final determination of the suitability for the use contemplated and its manner of use are the sole responsibility of the user. Structural and geotechnical design analysis shall be performed by a qualified engineer.

Any party accepting this document does so in confidence and agrees that it shall not be duplicated in whole or in part, nor disclosed to others without the consent of Keystone Retaining Wall Systems, Inc.

No.	Date	Revision	By



Designed By:
cdm

Checked By:

Date:
1/10/00

Specialty Applications

Title Sheet

Scale:

Project No:

Drawing No.

1

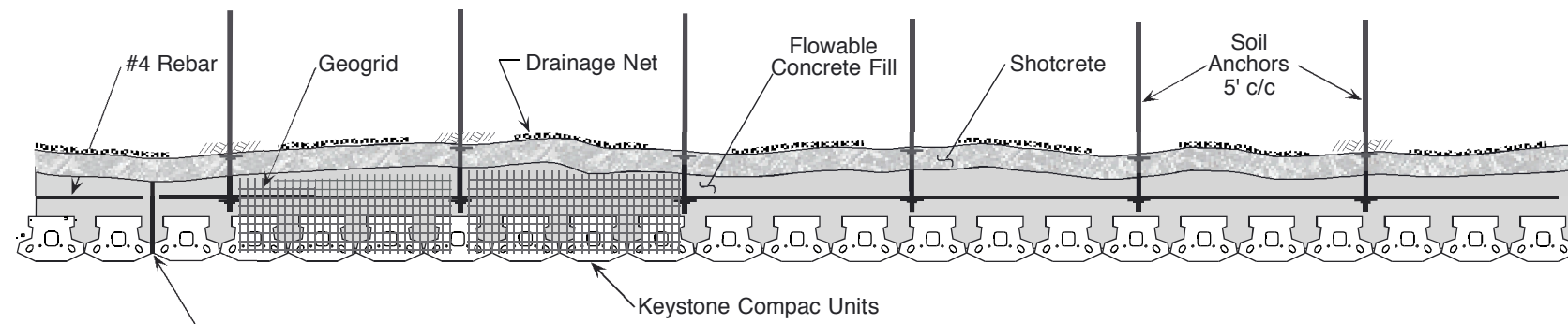

Typical Plan View

1/2" Expansion Joint Material
(50' c/c Maximum)

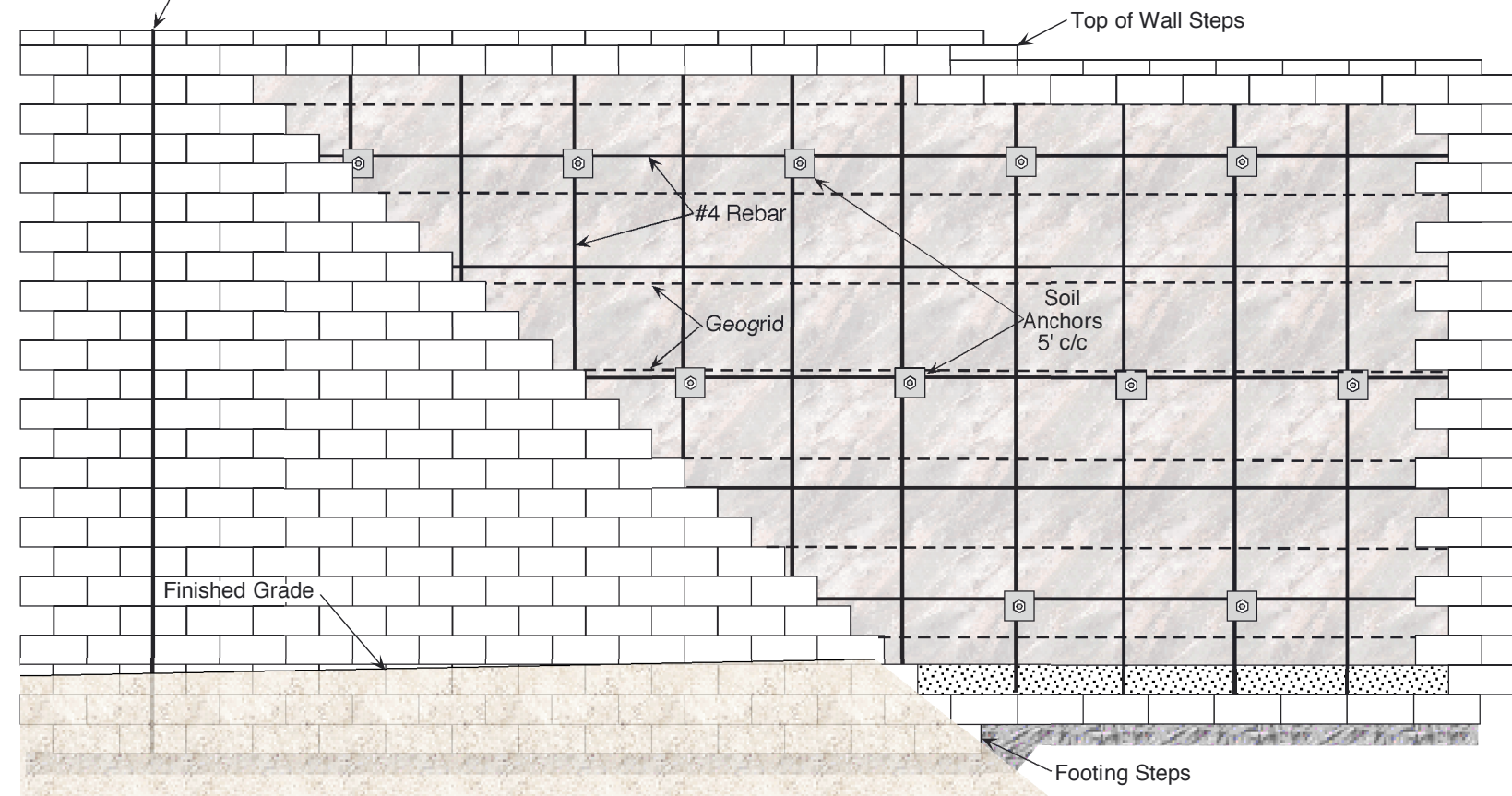

Typical Wall Elevation

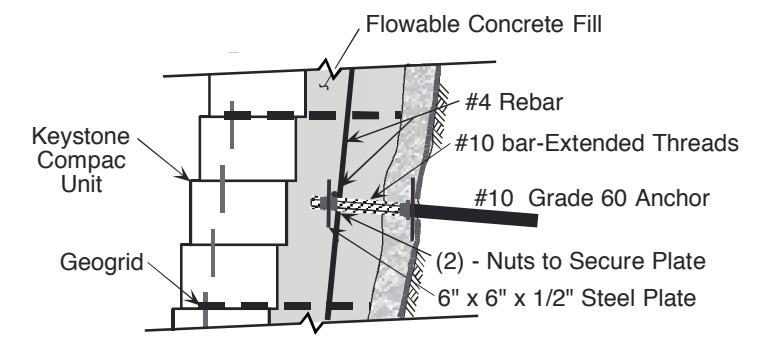

Typical Anchorage Detail

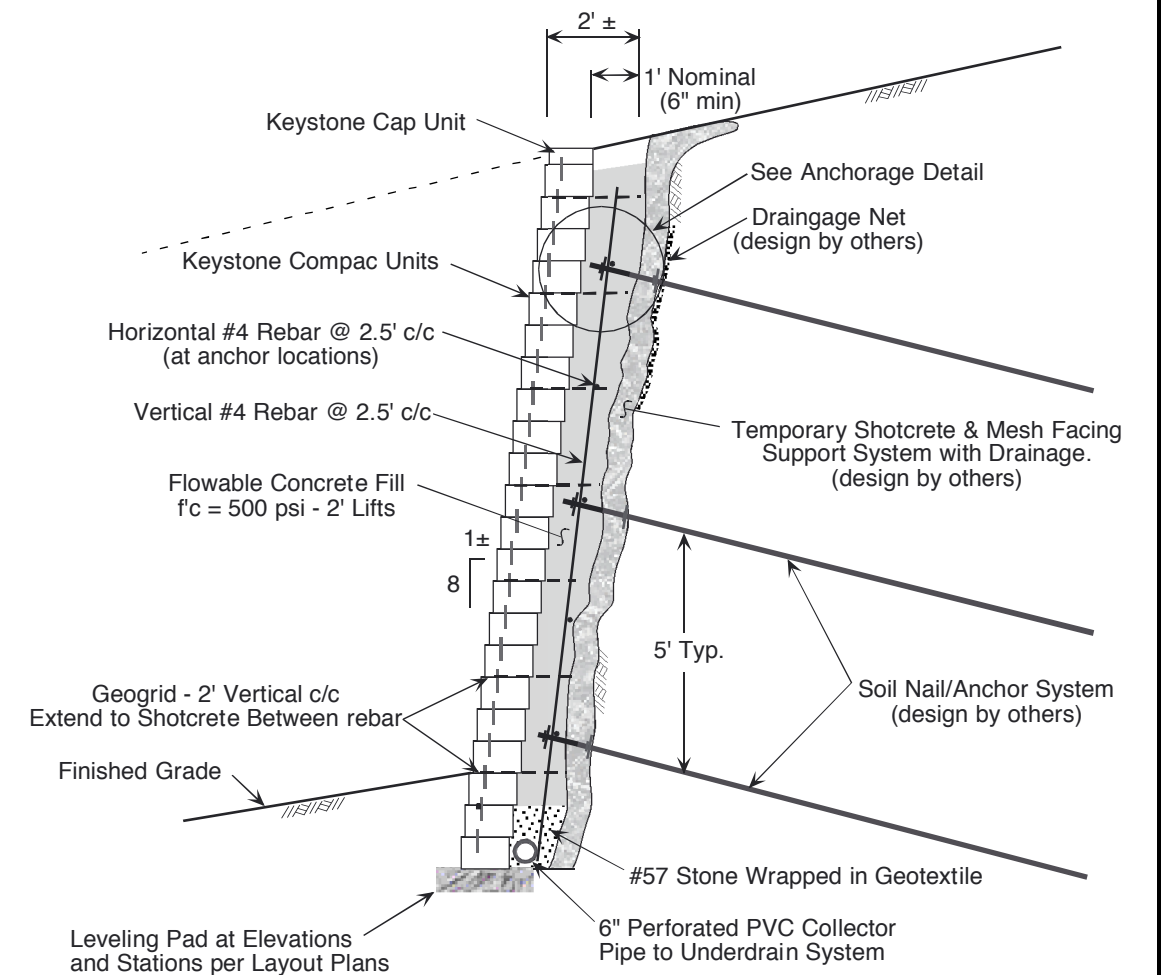

Typical Soil Nail/Anchor Section

COPYRIGHT (c) 2000 by Keystone Retaining Wall Systems, Inc.

The information contained herein has been compiled by Keystone Retaining Wall Systems and to the best of our knowledge, accurately represents the Keystone product use in the applications which are illustrated. This drawing is being furnished for design guidance and estimating only. Final determination of the suitability for the use contemplated and its manner of use are the sole responsibility of the user. Structural and geotechnical design analysis shall be performed by a qualified engineer.

Any party accepting this document does so in confidence and agrees that it shall not be duplicated in whole or in part, nor disclosed to others without the consent of Keystone Retaining Wall Systems, Inc.

No.	Date	Revision	By



Designed By:

cdm

Checked By:

Date:

1/10/00

Specialty Applications

Soil Nail Facing

Scale:

Project No:

Drawing No.

2

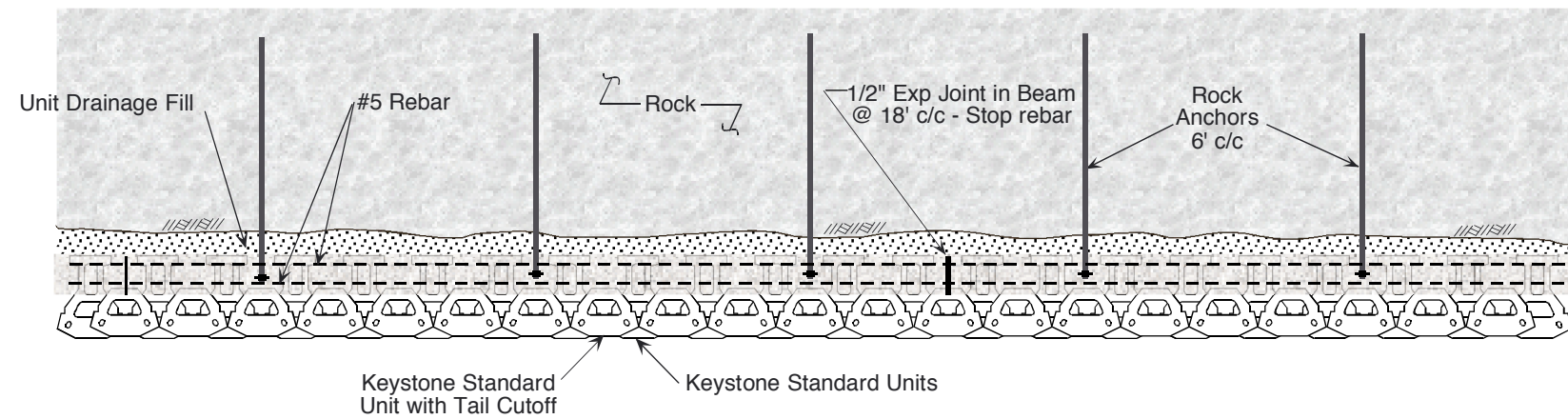

Typical Plan View

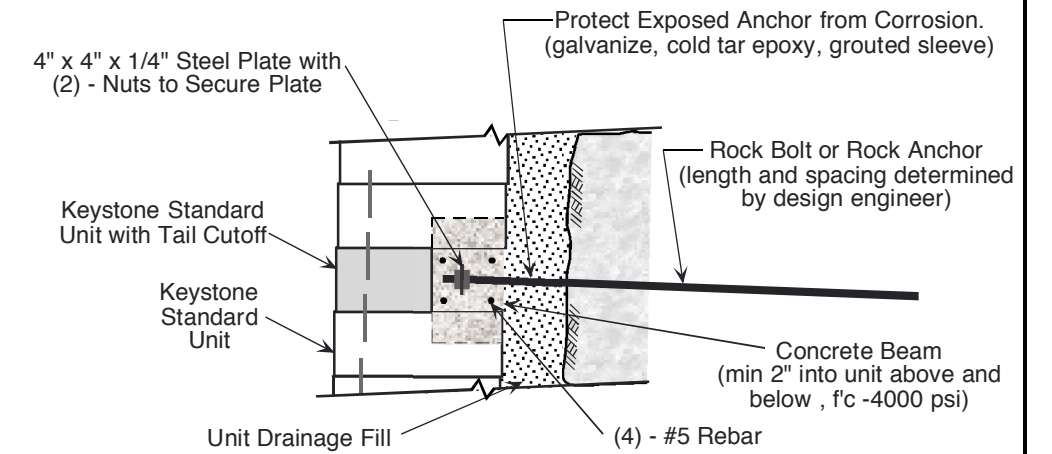

Typical Concrete Beam Detail

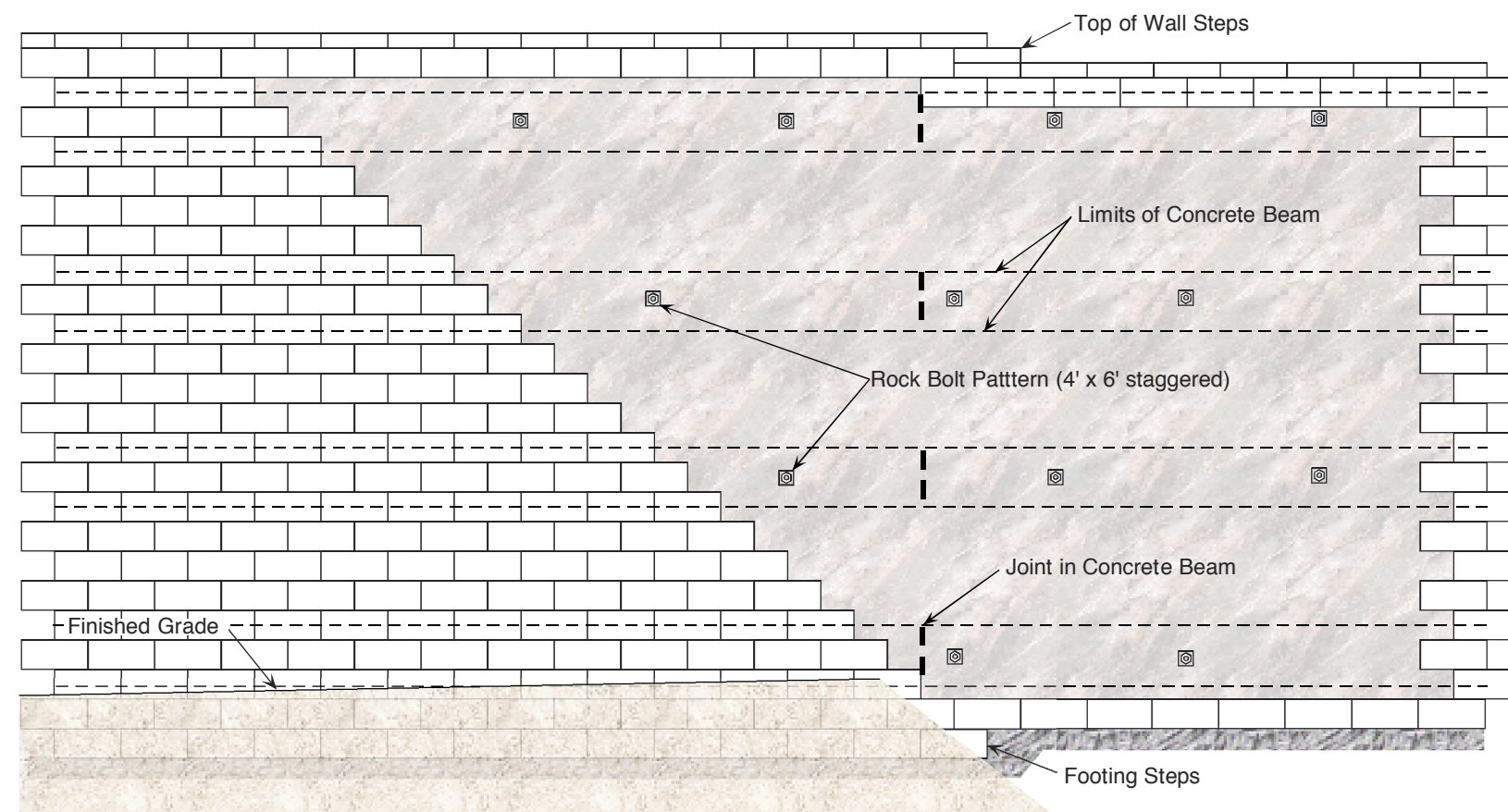

Typical Wall Elevation

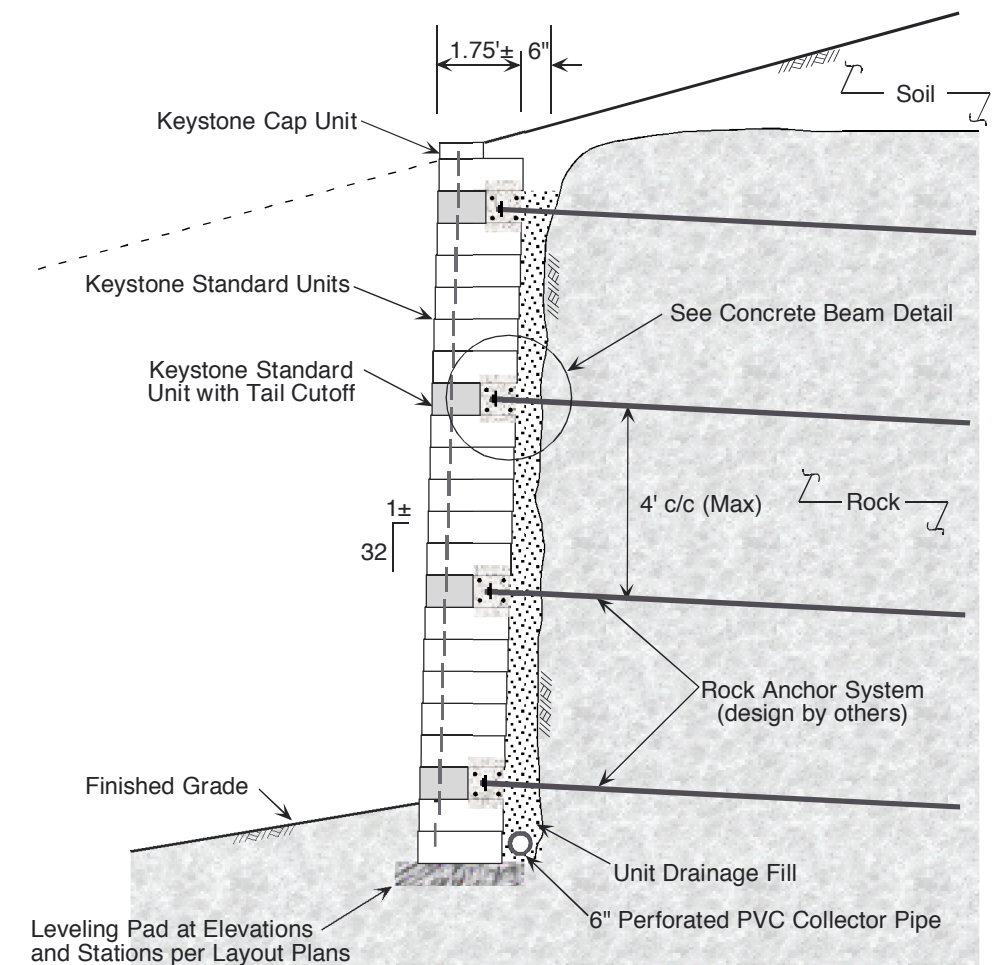

Typical Rock Facing Section

COPYRIGHT (c) 2000 by Keystone Retaining Wall Systems, Inc.

The information contained herein has been compiled by Keystone Retaining Wall Systems and to the best of our knowledge, accurately represents the Keystone product use in the applications which are illustrated. This drawing is being furnished for design guidance and estimating only. Final determination of the suitability for the use contemplated and its manner of use are the sole responsibility of the user. Structural and geotechnical design analysis shall be performed by a qualified engineer.

Any party accepting this document does so in confidence and agrees that it shall not be duplicated in whole or in part, nor disclosed to others without the consent of Keystone Retaining Wall Systems, Inc.

No.	Date	Revision	By



Designed By:
cdm

Checked By:

Date:
1/10/00

Specialty Applications

Rock/Shotcrete Facing

Scale:

Project No:

Drawing No.

3

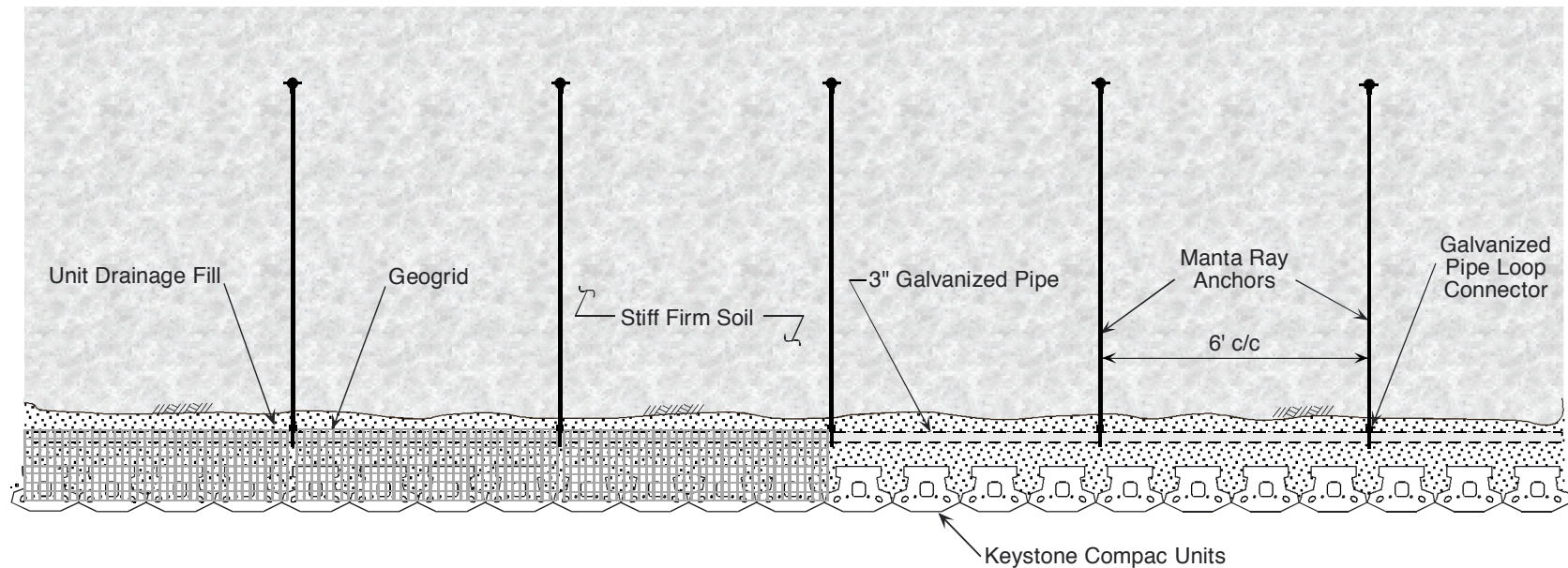

Typical Plan View

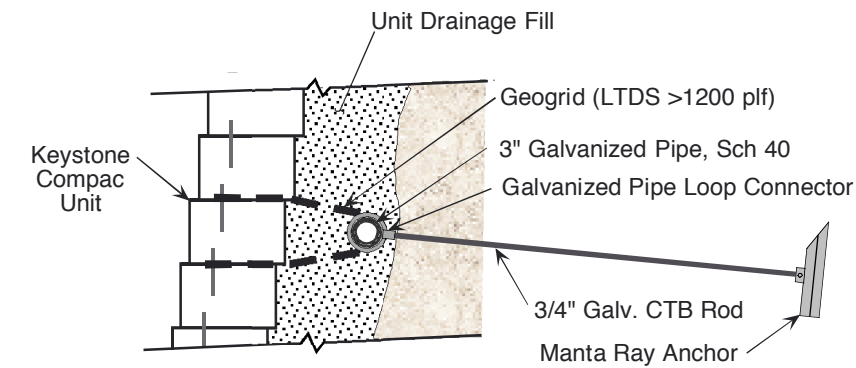

Typical Connector Detail

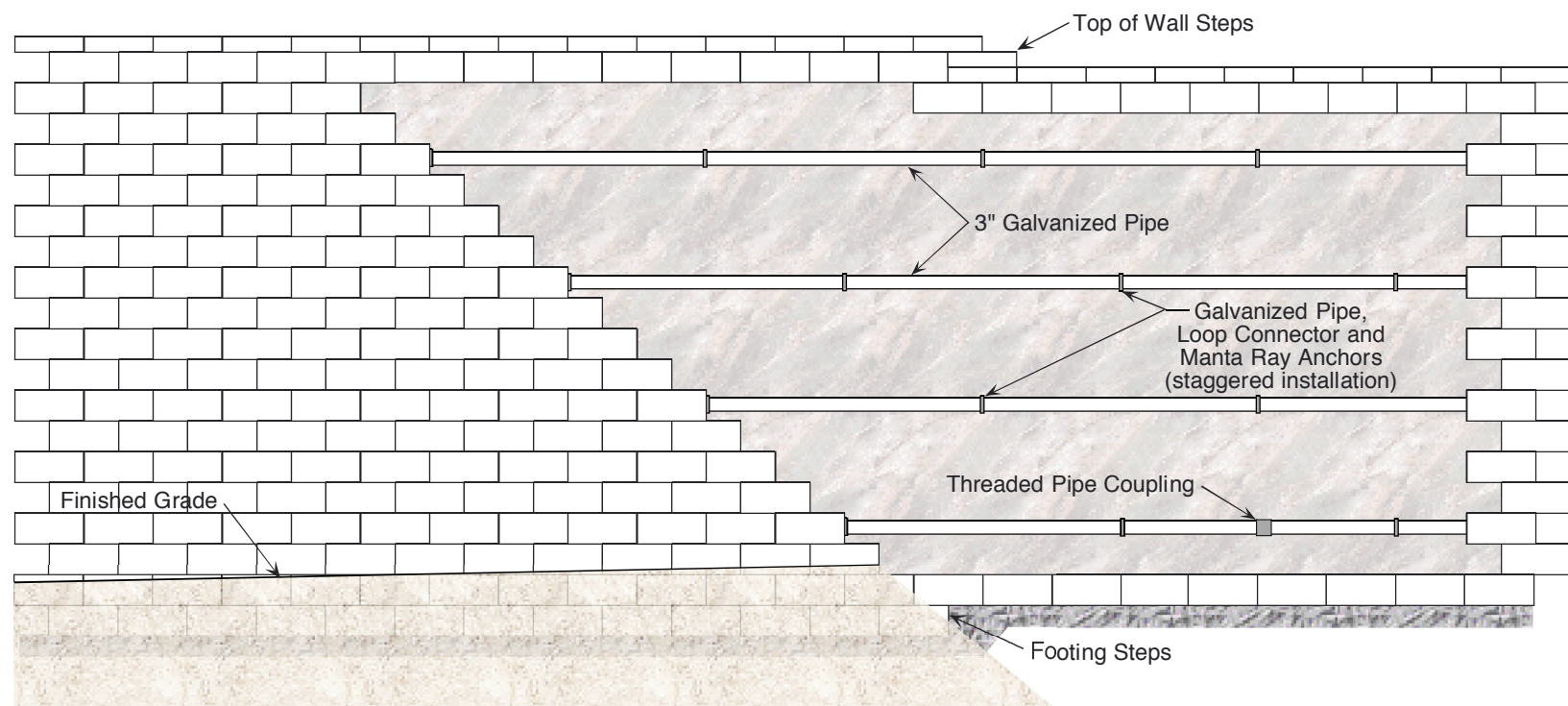

Typical Wall Elevation

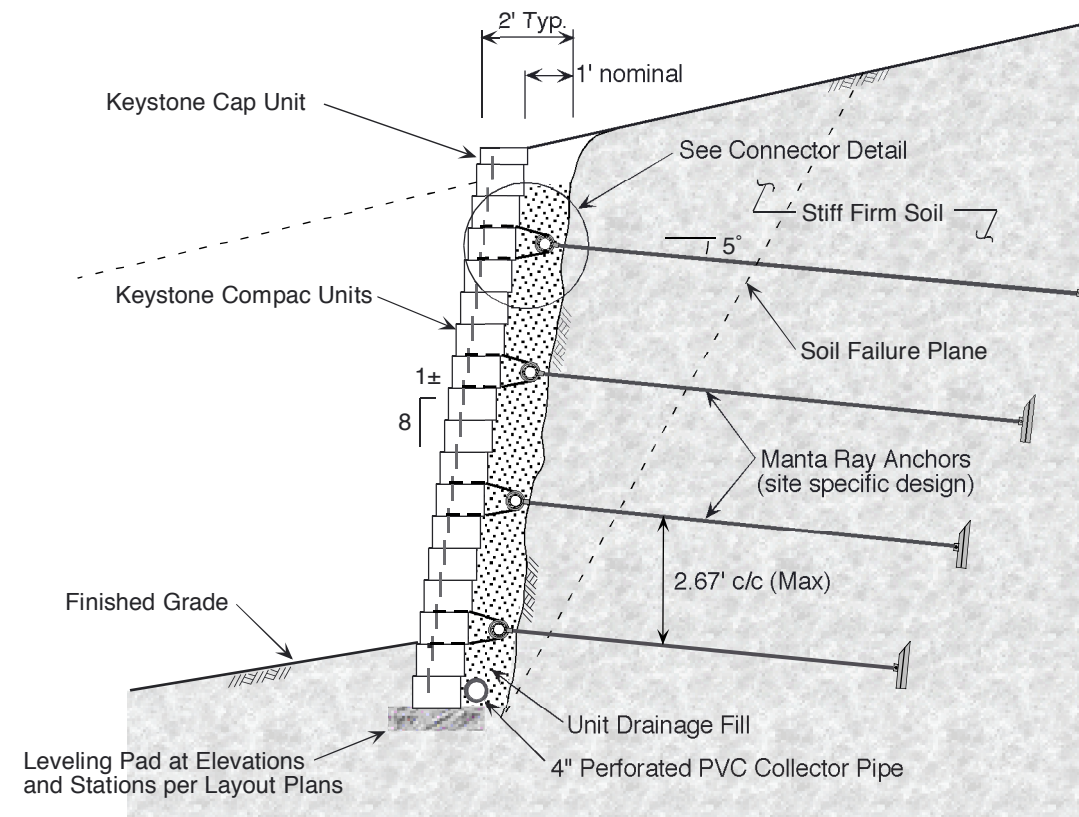

Typical Manta Ray Anchor Section

COPYRIGHT (c) 2000 by Keystone Retaining Wall Systems, Inc.

The information contained herein has been compiled by Keystone Retaining Wall Systems and to the best of our knowledge, accurately represents the Keystone product use in the applications which are illustrated. This drawing is being furnished for design guidance and estimating only. Final determination of the suitability for the use contemplated and its manner of use are the sole responsibility of the user. Structural and geotechnical design analysis shall be performed by a qualified engineer.

Any party accepting this document does so in confidence and agrees that it shall not be duplicated in whole or in part, nor disclosed to others without the consent of Keystone Retaining Wall Systems, Inc.

No.	Date	Revision	By



Designed By:
cdm
Checked By:
Date:
1/10/00

Specialty Applications

Manta Ray Anchor Facing

Project No:
Drawing No. 4

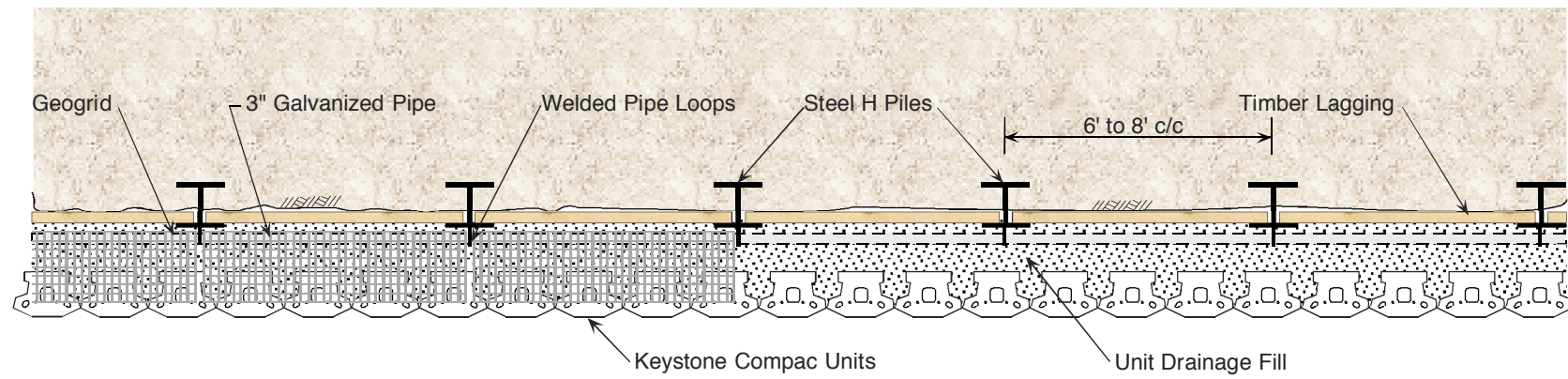

Typical Plan View

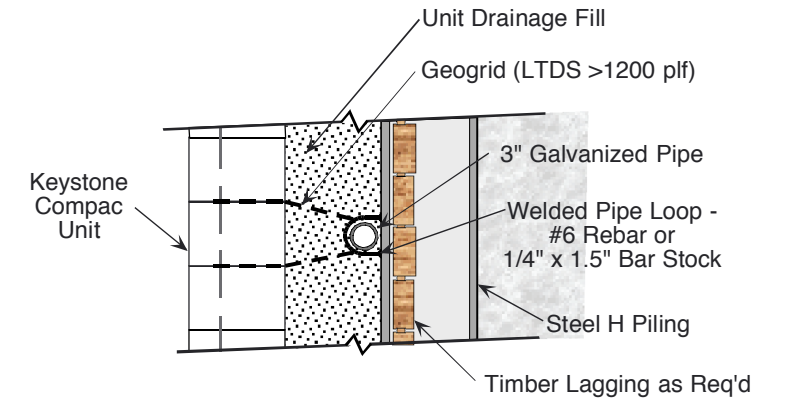

Typical Connector Detail

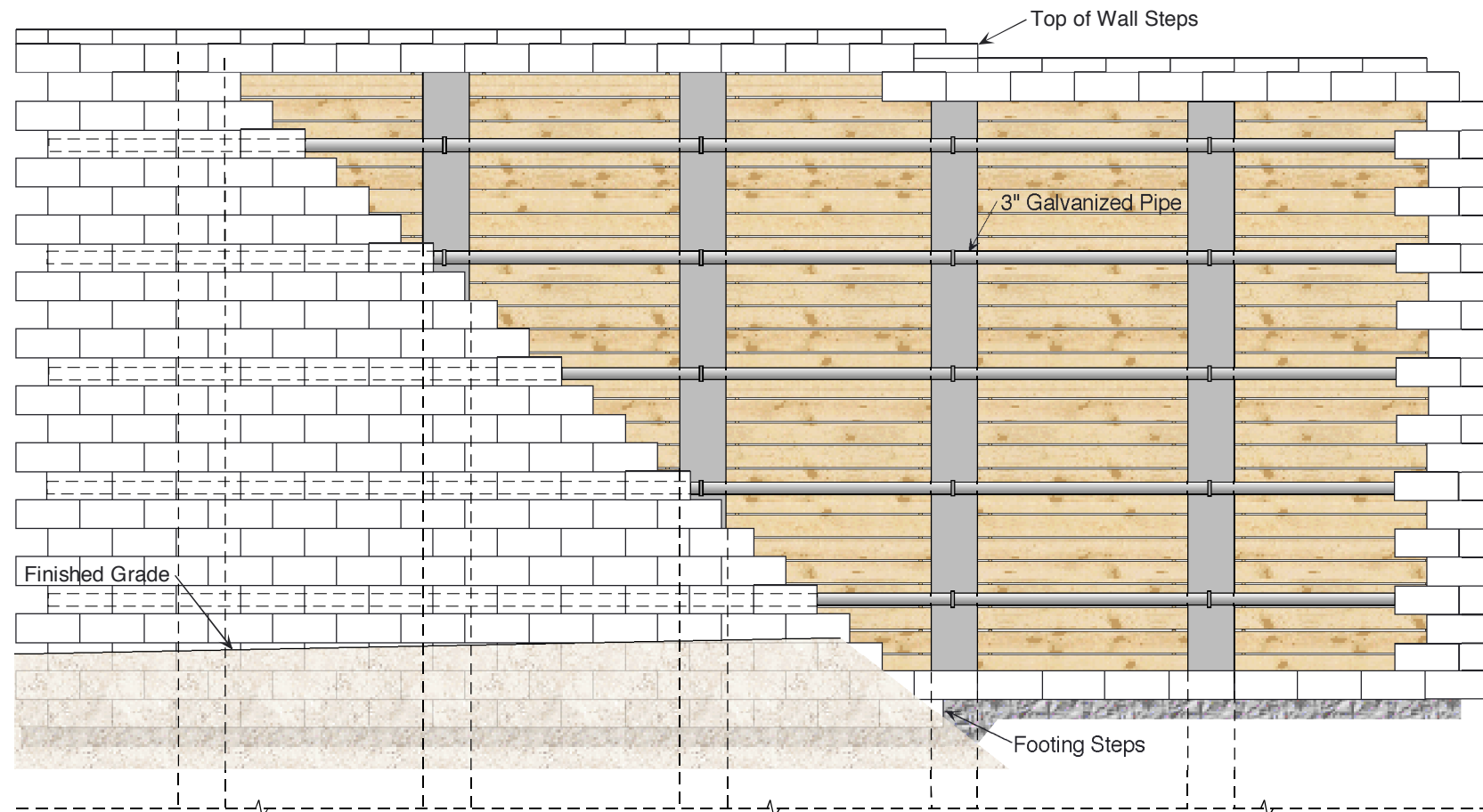

Typical Wall Elevation

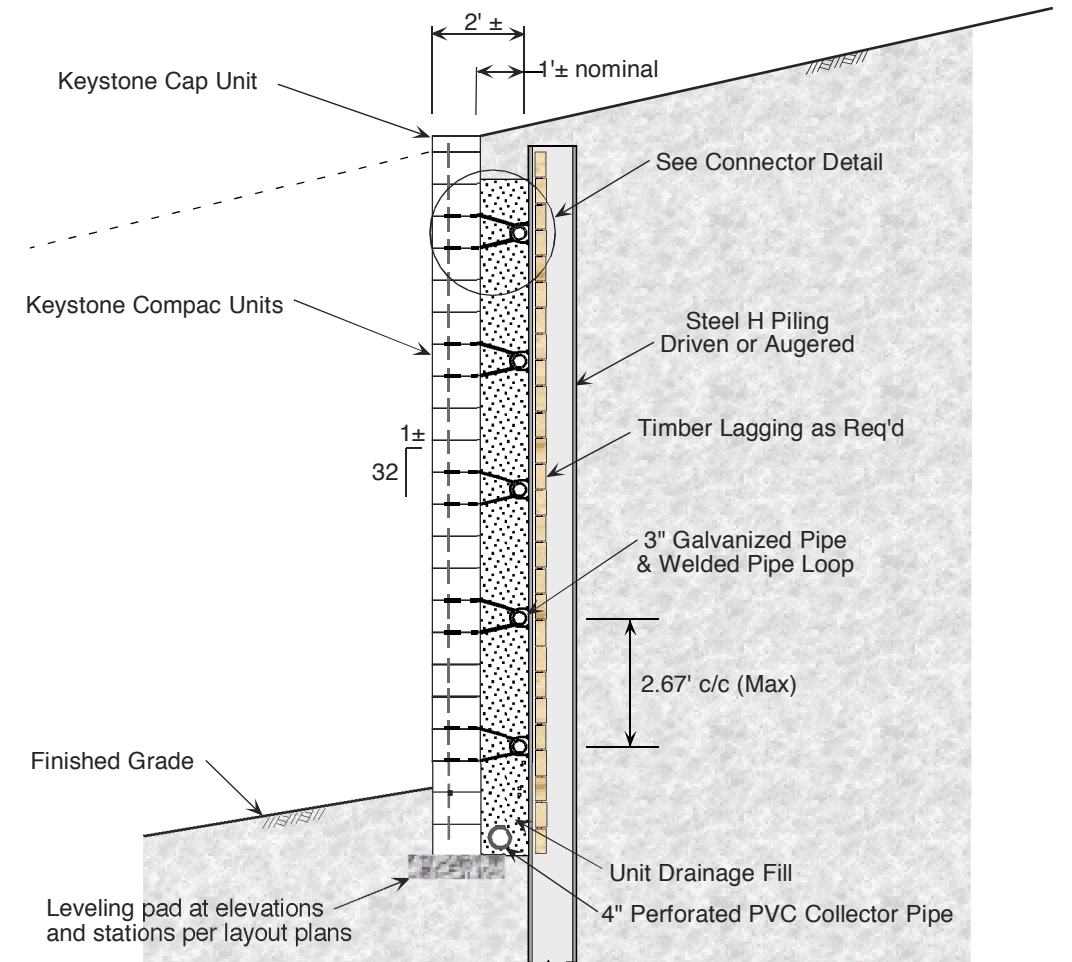

Typical Pile & Lagging Wall Section

COPYRIGHT (c) 2000 by Keystone Retaining Wall Systems, Inc.

The information contained herein has been compiled by Keystone Retaining Wall Systems and to the best of our knowledge, accurately represents the Keystone product use in the applications which are illustrated. This drawing is being furnished for design guidance and estimating only. Final determination of the suitability for the use contemplated and its manner of use are the sole responsibility of the user. Structural and geotechnical design analysis shall be performed by a qualified engineer.

Any party accepting this document does so in confidence and agrees that it shall not be duplicated in whole or in part, nor disclosed to others without the consent of Keystone Retaining Wall Systems, Inc.

No.	Date	Revision	By



Designed By:
cdm
Checked By:
Date:
1/10/00

Specialty Applications

Soldier Pile Facing

Project No: _____ Drawing No. 5

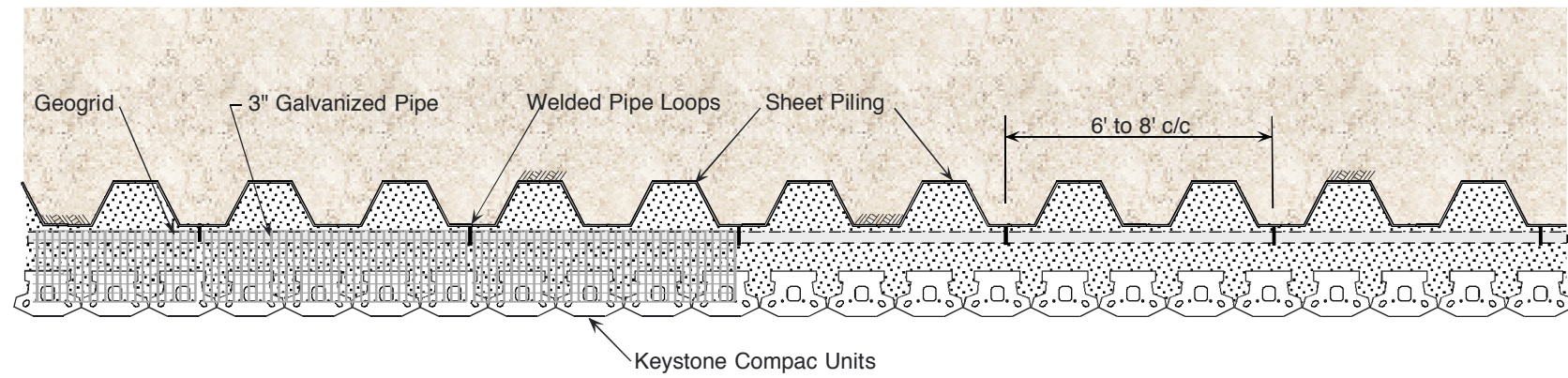

Typical Plan View

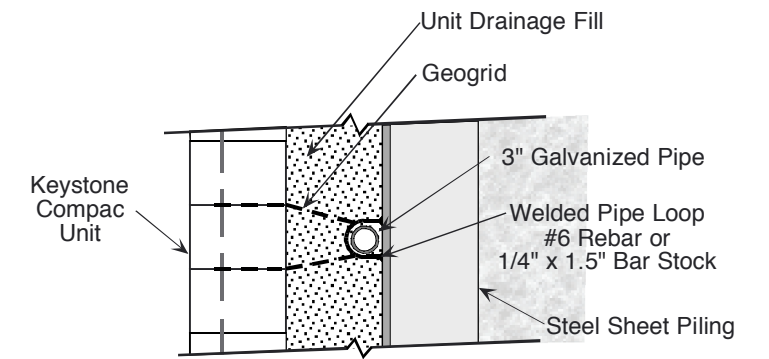

Typical Connector Detail

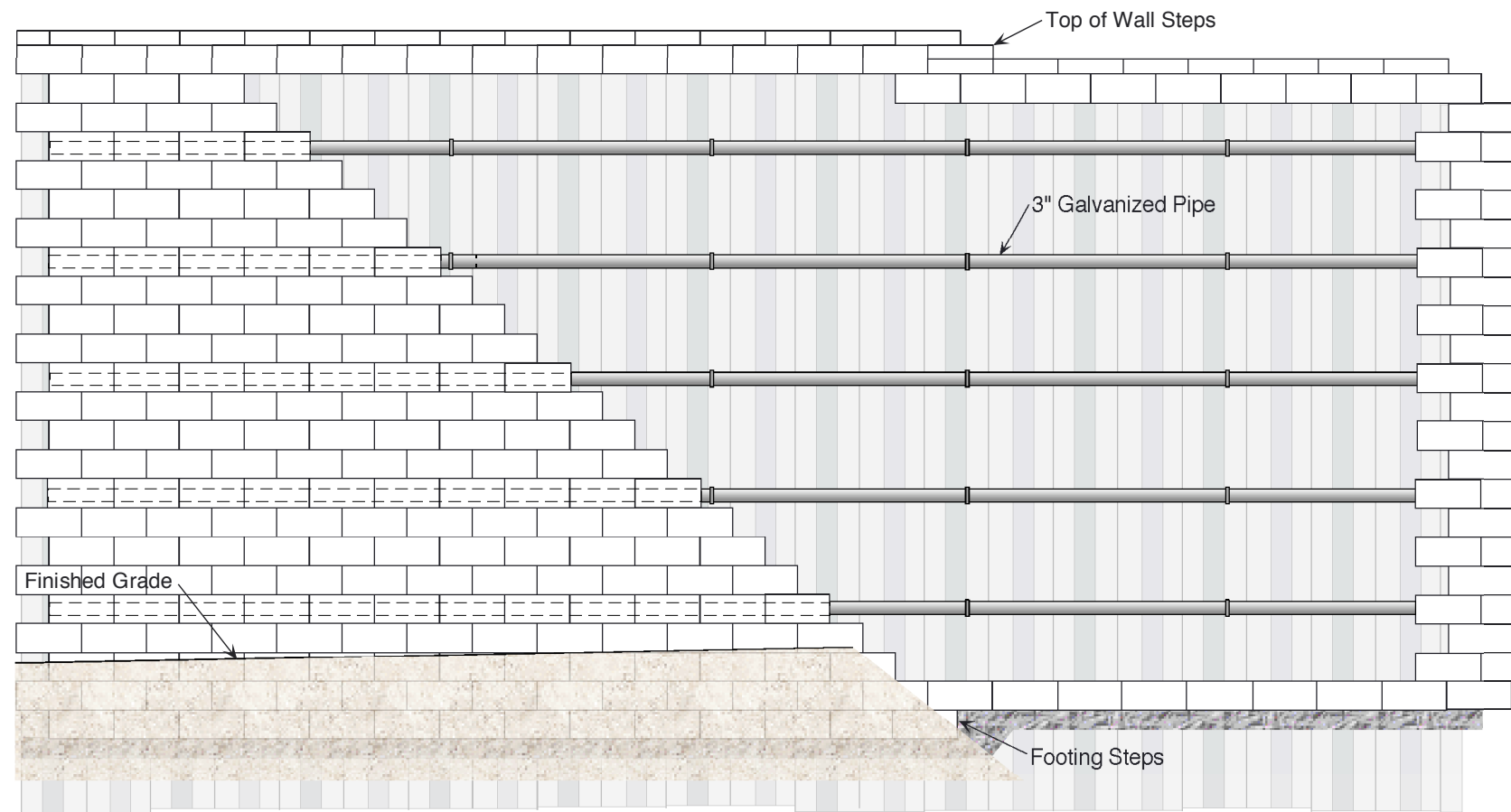

Typical Wall Elevation

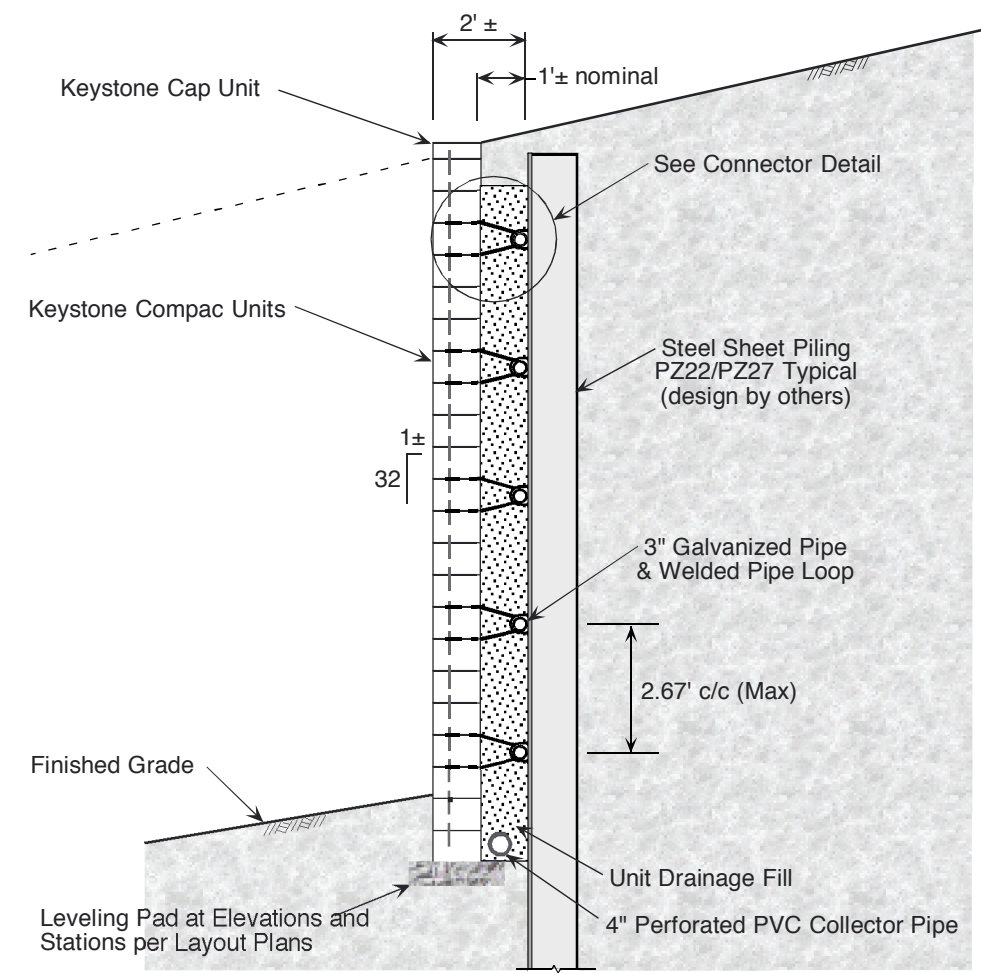

Typical Sheet Piling Wall Section

COPYRIGHT (c) 2000 by Keystone Retaining Wall Systems, Inc.
 The information contained herein has been compiled by Keystone Retaining Wall Systems and to the best of our knowledge, accurately represents the Keystone product use in the applications which are illustrated. This drawing is being furnished for design guidance and estimating only. Final determination of the suitability for the use contemplated and its manner of use are the sole responsibility of the user. Structural and geotechnical design analysis shall be performed by a qualified engineer.
 Any party accepting this document does so in confidence and agrees that it shall not be duplicated in whole or in part, nor disclosed to others without the consent of Keystone Retaining Wall Systems, Inc.

No.	Date	Revision	By



Designed By:
cdm
 Checked By:
 Date:
1/10/00

Specialty Applications
 Scale:

Sheet Pile Facing
 Project No:
 Drawing No. 6

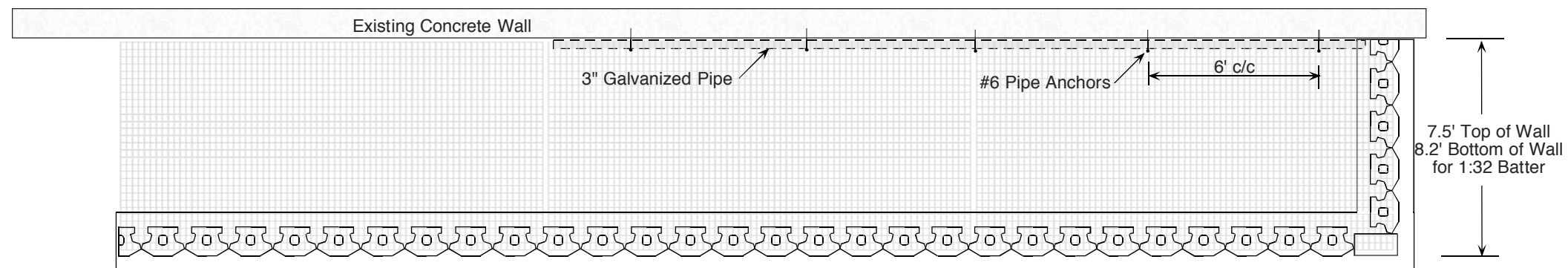

Plan View - Front Face

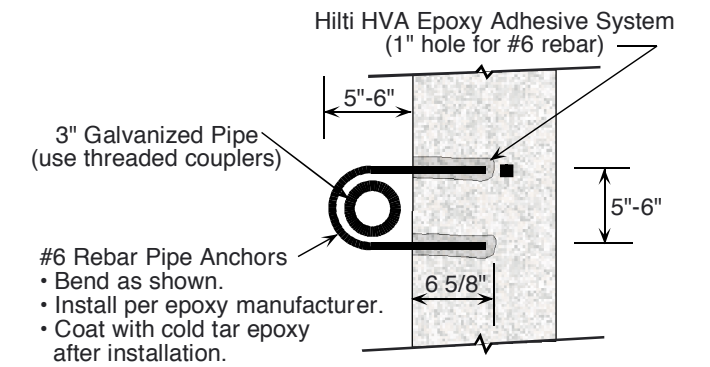

Pipe Anchor Detail

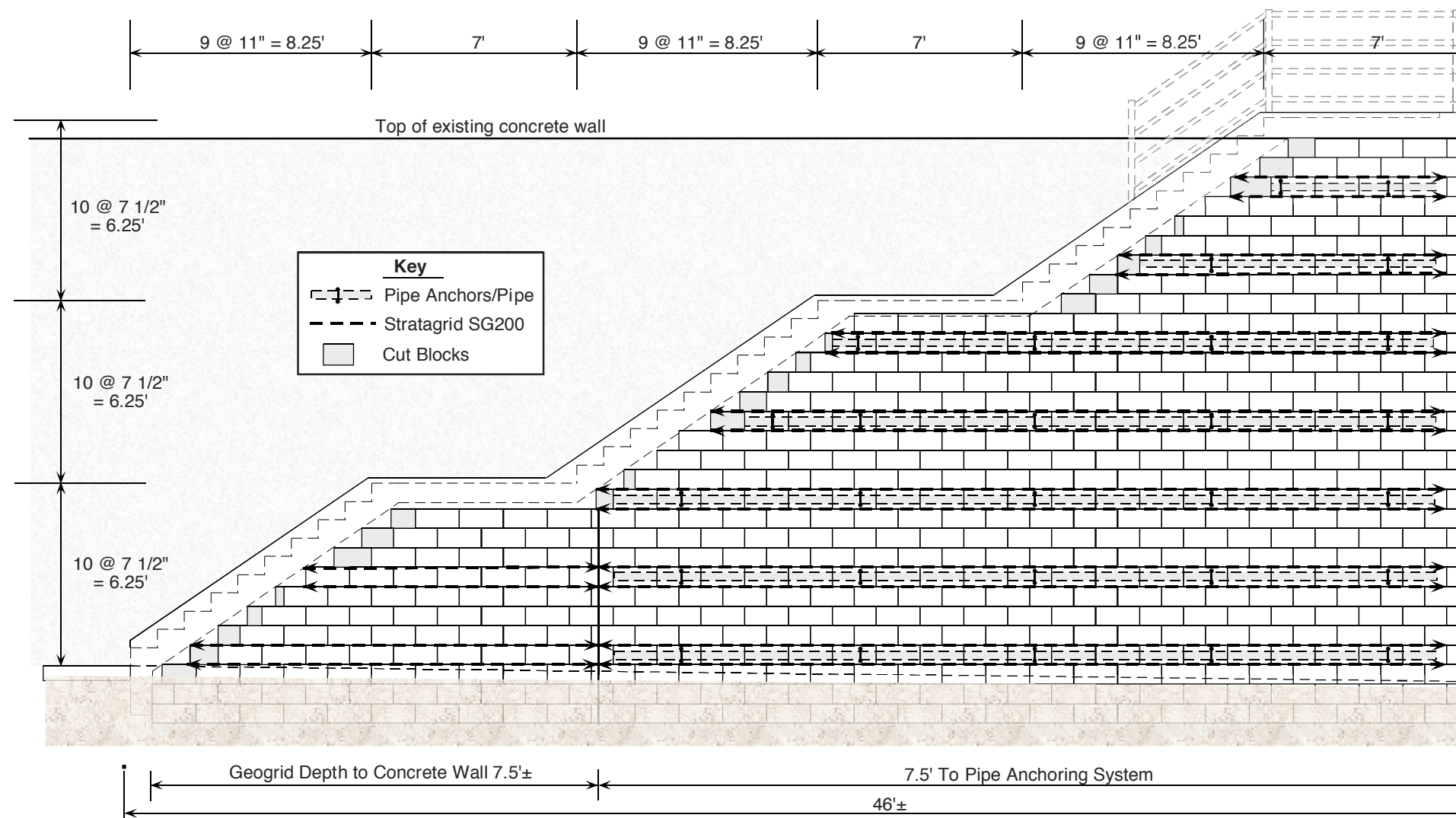

Elevation - Front Face

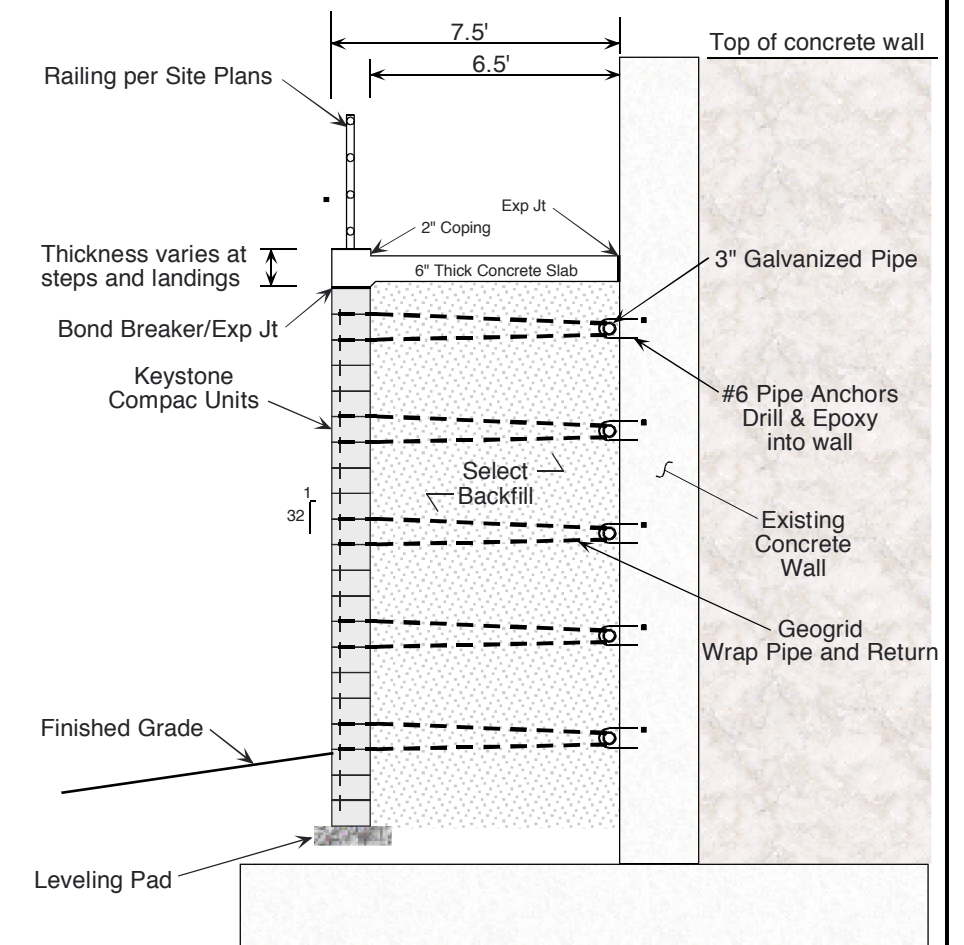

Typical Section - Second Landing

COPYRIGHT (c) 2000 by Keystone Retaining Wall Systems, Inc.

The information contained herein has been compiled by Keystone Retaining Wall Systems and to the best of our knowledge, accurately represents the Keystone product use in the applications which are illustrated. This drawing is being furnished for design guidance and estimating only. Final determination of the suitability for the use contemplated and its manner of use are the sole responsibility of the user. Structural and geotechnical design analysis shall be performed by a qualified engineer.

Any party accepting this document does so in confidence and agrees that it shall not be duplicated in whole or in part, nor disclosed to others without the consent of Keystone Retaining Wall Systems, Inc.

No.	Date	Revision	By



Designed By:
cdm

Checked By:

Date:
1/10/00

Specialty Applications

Stairway Facing/ Concrete Wall

Project No:

Drawing No. 7

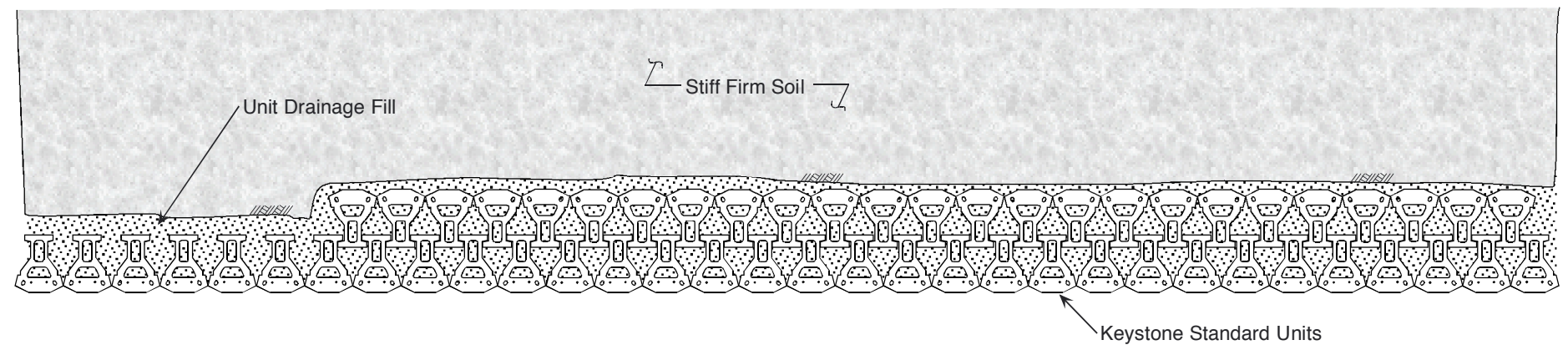

Typical Plan View

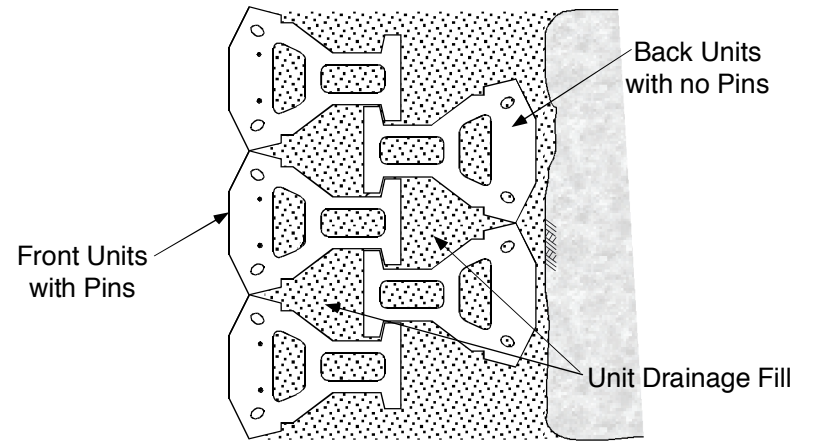

Typical Detail

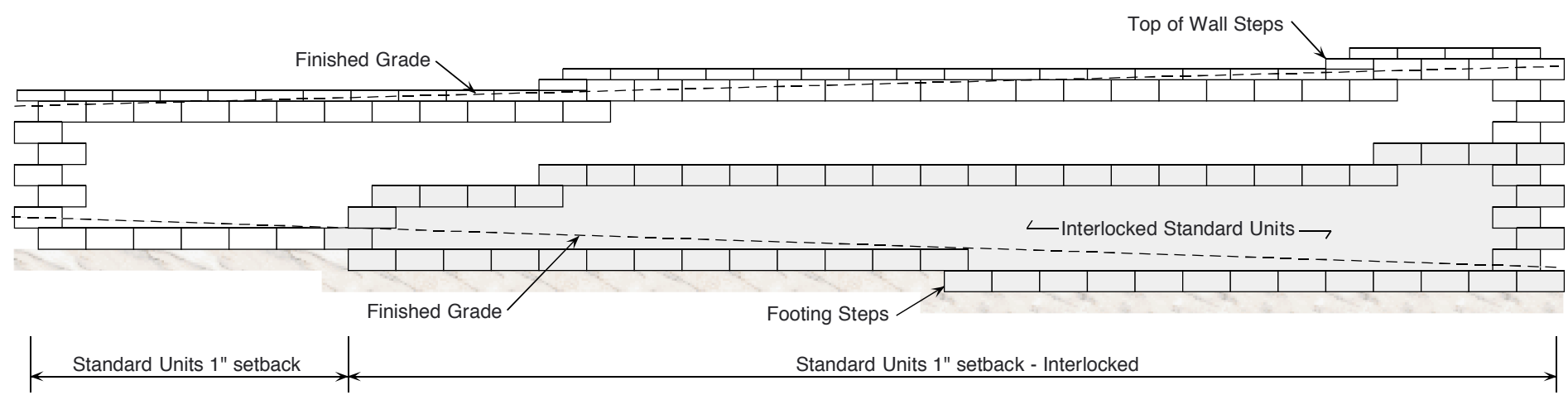

Typical Wall Elevation

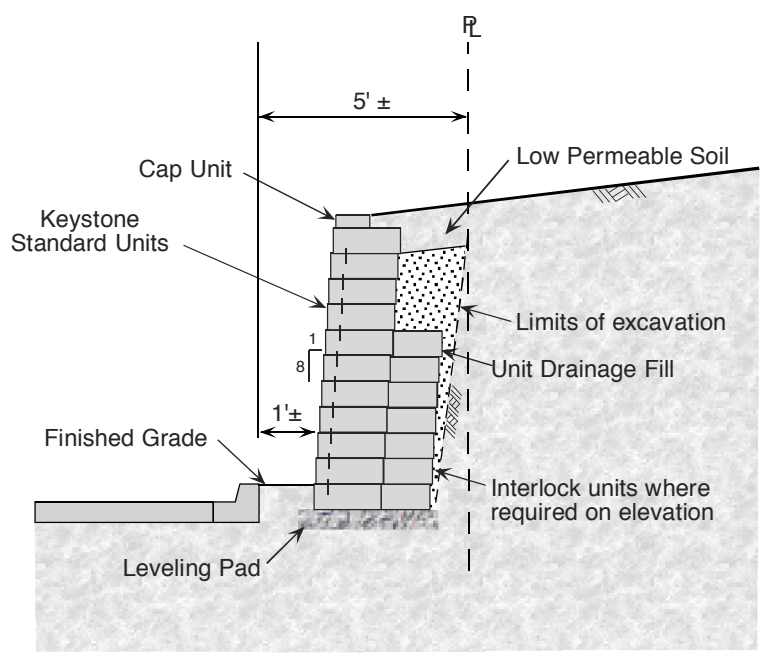

Typical Interlocked Wall Section

COPYRIGHT (c) 2000 by Keystone Retaining Wall Systems, Inc.
 The information contained herein has been compiled by Keystone Retaining Wall Systems and to the best of our knowledge, accurately represents the Keystone product use in the applications which are illustrated. This drawing is being furnished for design guidance and estimating only. Final determination of the suitability for the use contemplated and its manner of use are the sole responsibility of the user. Structural and geotechnical design analysis shall be performed by a qualified engineer.
 Any party accepting this document does so in confidence and agrees that it shall not be duplicated in whole or in part, nor disclosed to others without the consent of Keystone Retaining Wall Systems, Inc.

No.	Date	Revision	By



Designed By:
cdm
 Checked By:
 Date:
1/10/00

Specialty Applications

Interlocking Standard Units
 Project No:
 Drawing No. 8

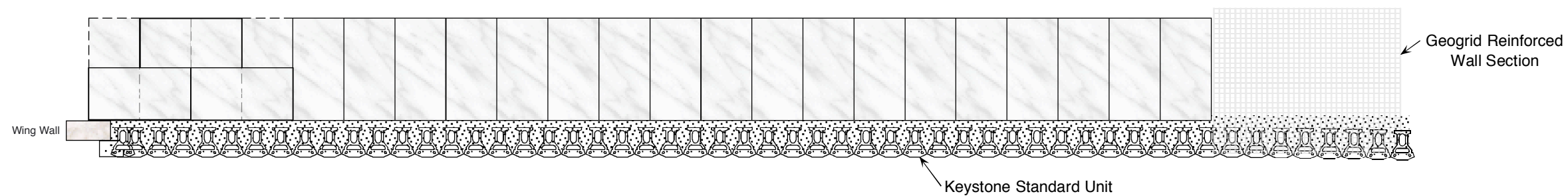

Typical Wall Plan

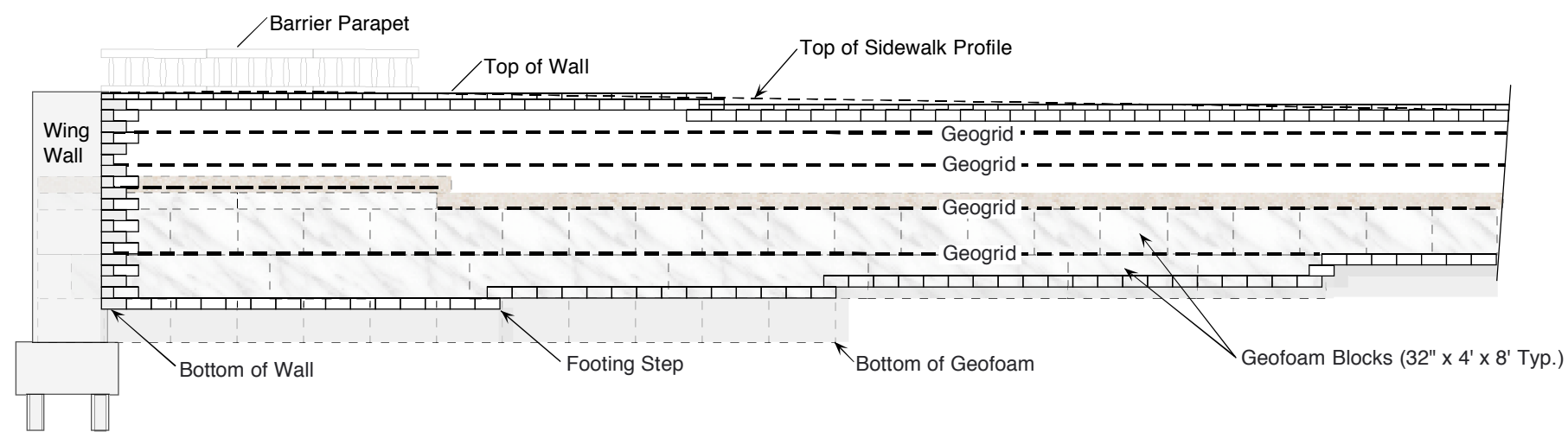

Elevation - Front Face

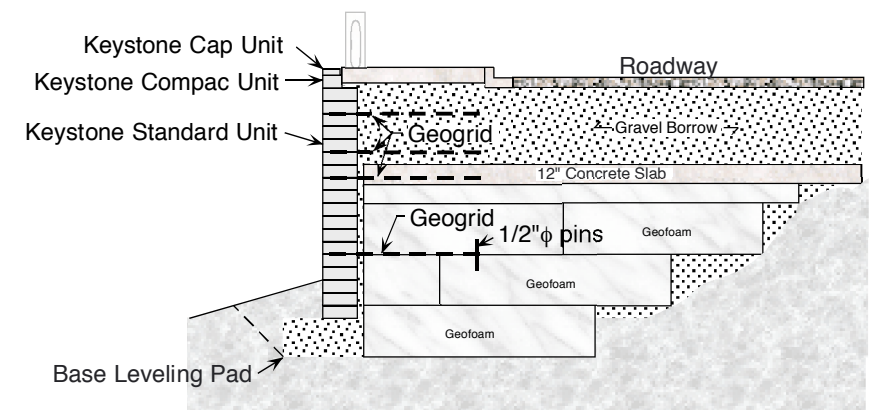

Typical Section

COPYRIGHT (c) 2000 by Keystone Retaining Wall Systems, Inc.

The information contained herein has been compiled by Keystone Retaining Wall Systems and to the best of our knowledge, accurately represents the Keystone product use in the applications which are illustrated. This drawing is being furnished for design guidance and estimating only. Final determination of the suitability for the use contemplated and its manner of use are the sole responsibility of the user. Structural and geotechnical design analysis shall be performed by a qualified engineer.

Any party accepting this document does so in confidence and agrees that it shall not be duplicated in whole or in part, nor disclosed to others without the consent of Keystone Retaining Wall Systems, Inc.

No.	Date	Revision	By



Designed By:
cdm
Checked By:
Date:
1/10/00

Specialty Applications

Keystone/Geofoam Wall

Project No: Drawing No. 9

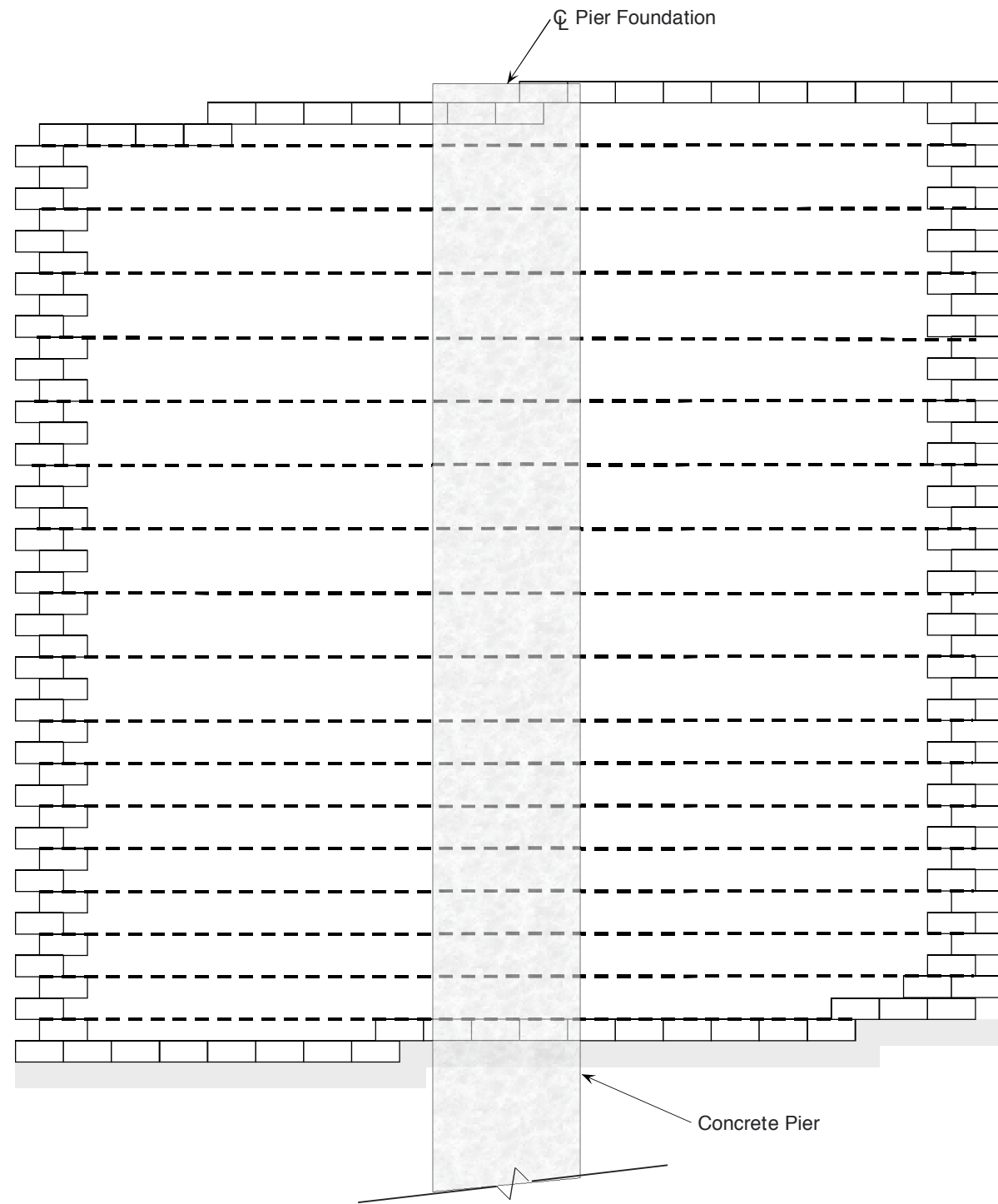

Wall Elevation @ Pier

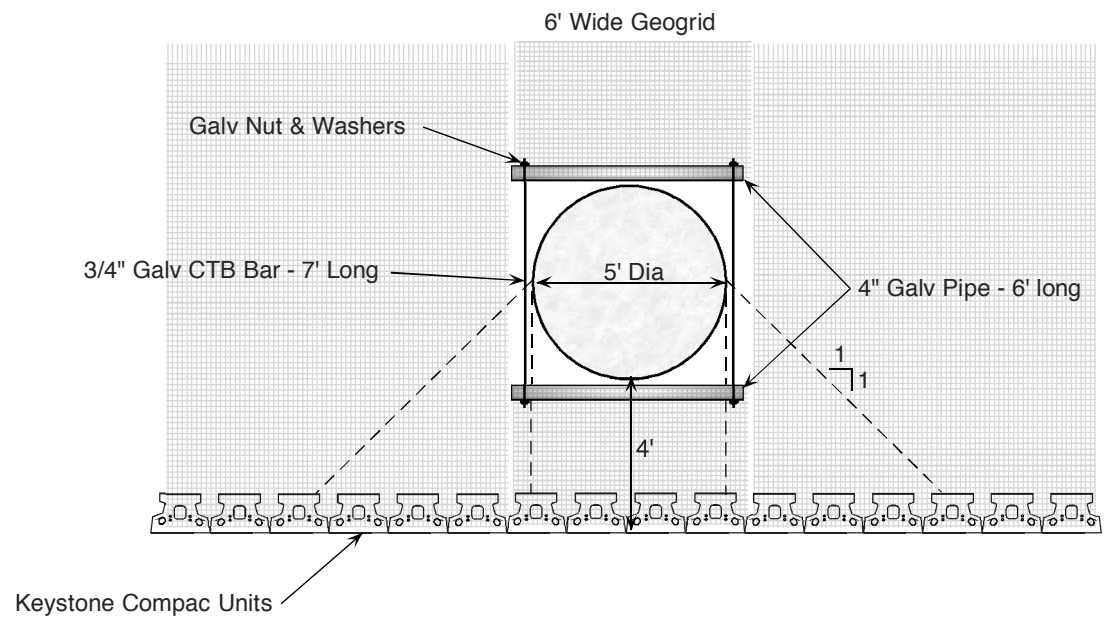

Wall Plan @ Pier

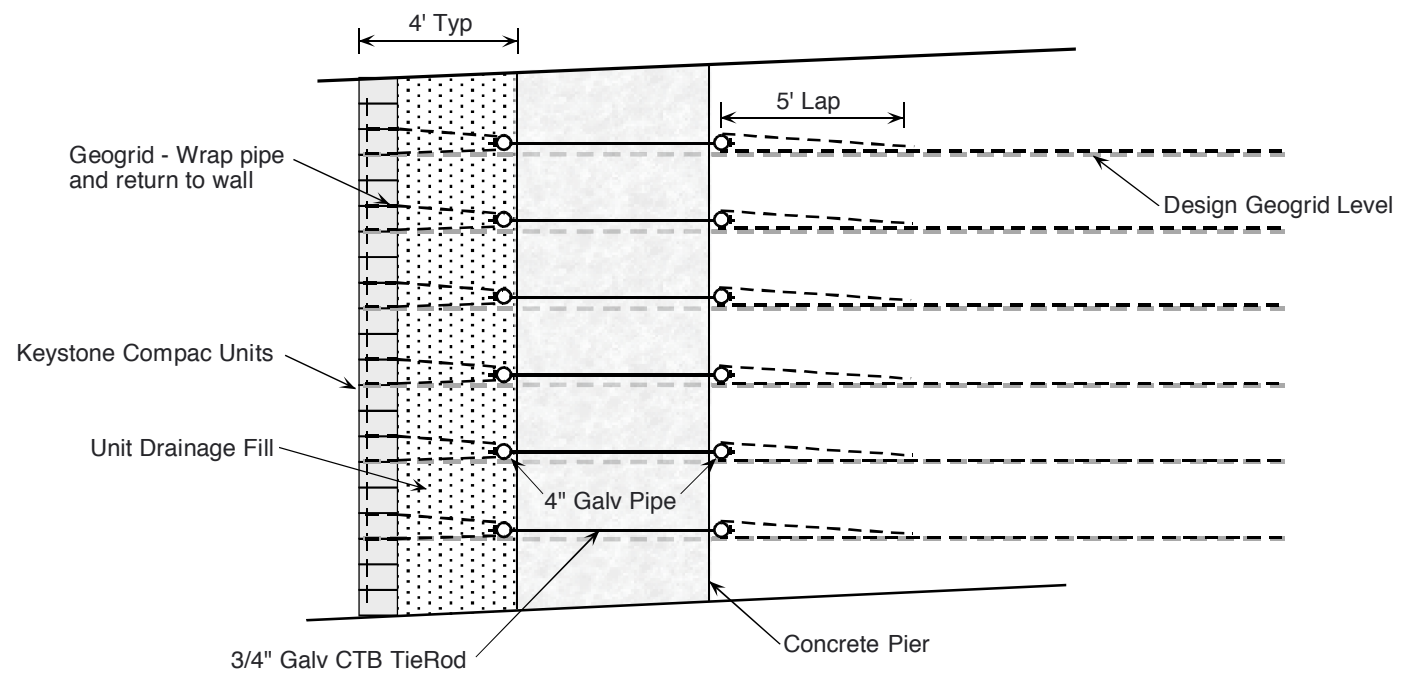

Wall Section @ Pier

COPYRIGHT (c) 2000 by Keystone Retaining Wall Systems, Inc.

The information contained herein has been compiled by Keystone Retaining Wall Systems and to the best of our knowledge, accurately represents the Keystone product use in the applications which are illustrated. This drawing is being furnished for design guidance and estimating only. Final determination of the suitability for the use contemplated and its manner of use are the sole responsibility of the user. Structural and geotechnical design analysis shall be performed by a qualified engineer.

Any party accepting this document does so in confidence and agrees that it shall not be duplicated in whole or in part, nor disclosed to others without the consent of Keystone Retaining Wall Systems, Inc.

No.	Date	Revision	By



Designed By:

cdm

Checked By:

Date:
1/10/00

Specialty Applications	
Scale:	

Foundation Obstruction	
Project No:	
Drawing No.	10

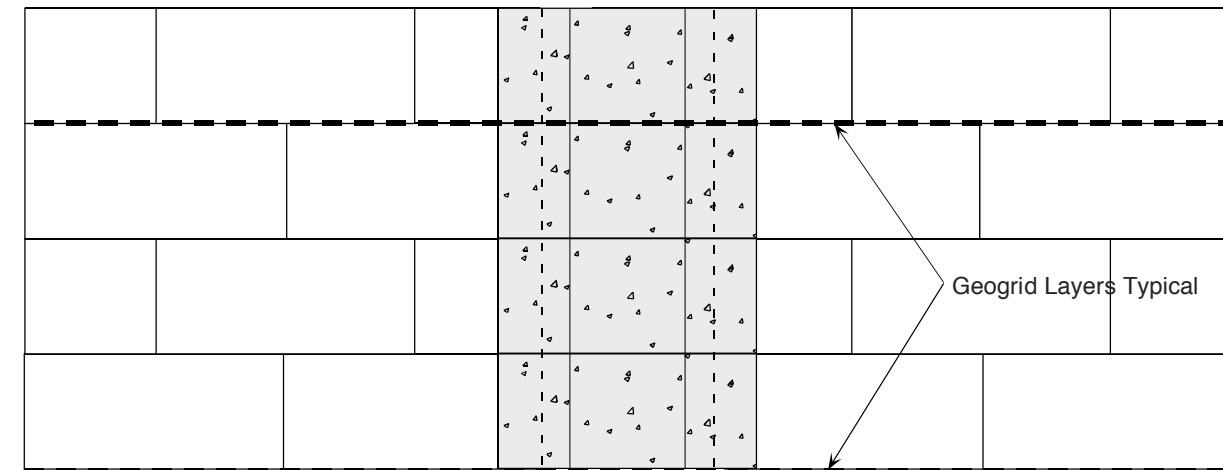
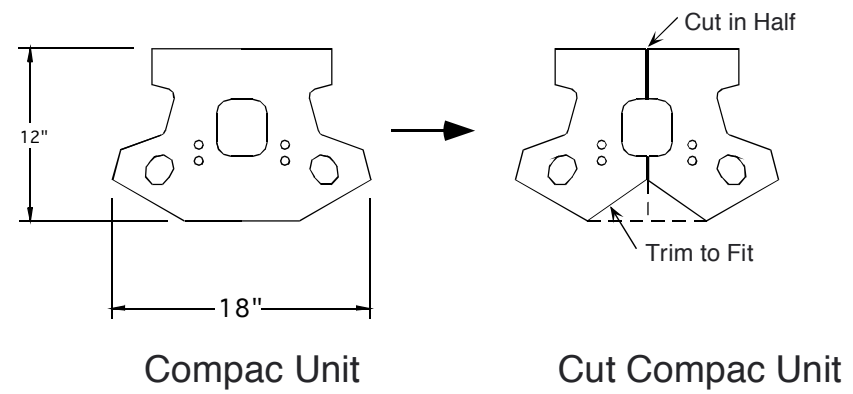
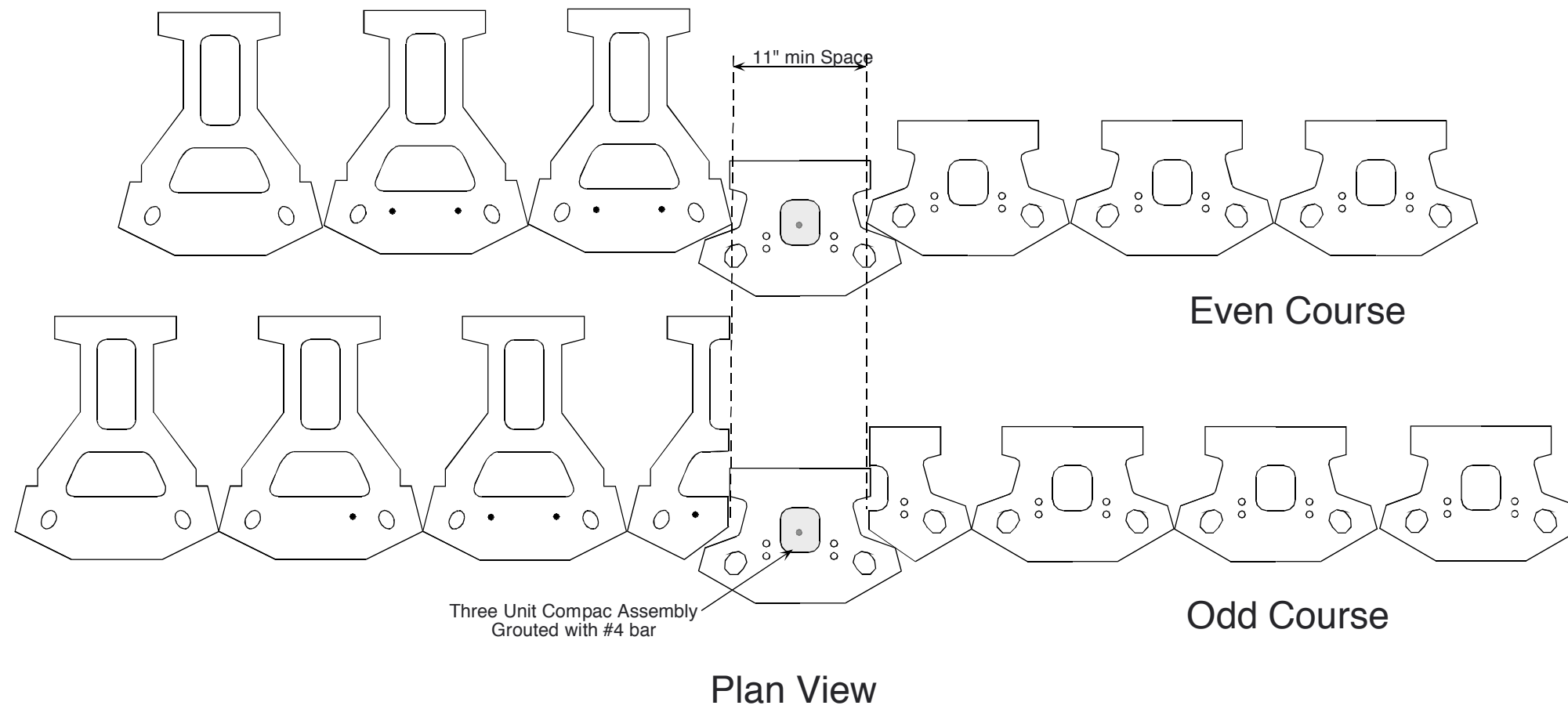

Front Elevation

COPYRIGHT (c) 2000 by Keystone Retaining Wall Systems, Inc.

The information contained herein has been compiled by Keystone Retaining Wall Systems and to the best of our knowledge, accurately represents the Keystone product use in the applications which are illustrated. This drawing is being furnished for design guidance and estimating only. Final determination of the suitability for the use contemplated and its manner of use are the sole responsibility of the user. Structural and geotechnical design analysis shall be performed by a qualified engineer.

Any party accepting this document does so in confidence and agrees that it shall not be duplicated in whole or in part, nor disclosed to others without the consent of Keystone Retaining Wall Systems, Inc.

No.	Date	Revision	By



Designed By:
cdm

Checked By:

Date:
1/10/00

Specialty Applications

Slip Joint Installation

Project No:

Drawing No.

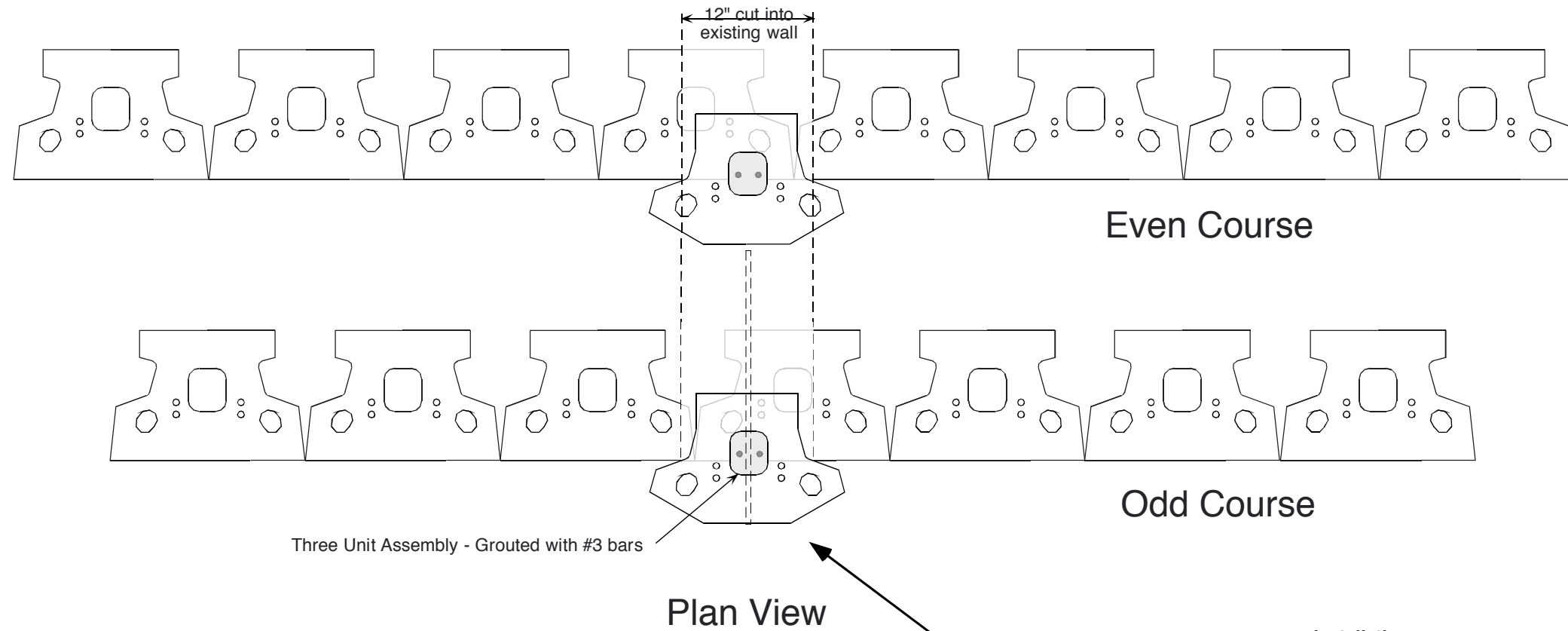

- Installation**
1. Cut out wall in 3-4 unit segments.
 2. Drive anchor into backfill and lock.
 3. Install three unit slip joint segment.
 4. Repeat as required.

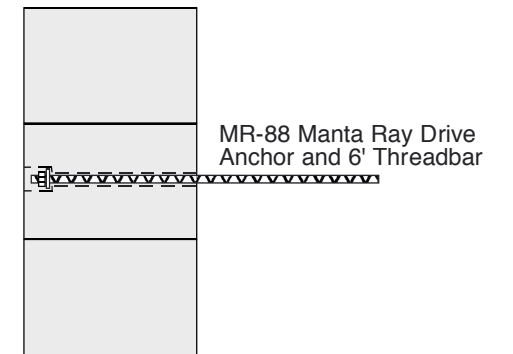
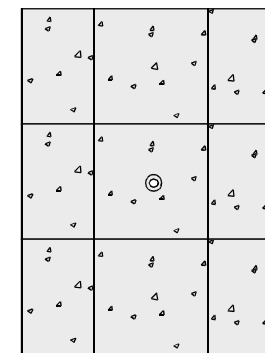
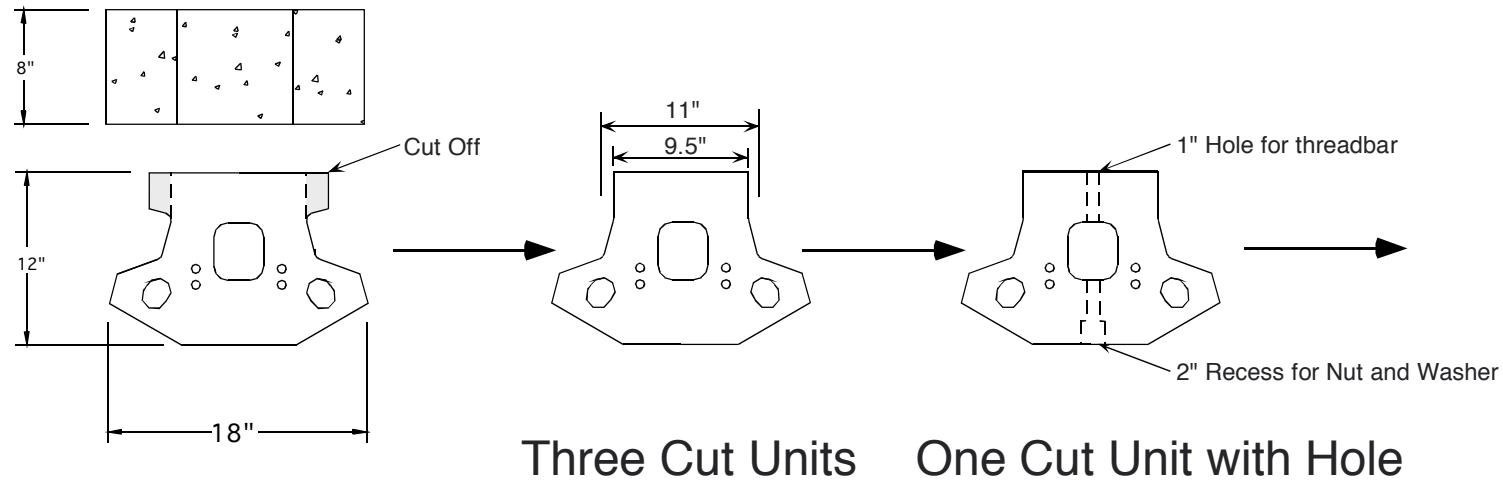

3 Unit Assembly

Anchored 3 Unit Assembly

COPYRIGHT (c) 2000 by Keystone Retaining Wall Systems, Inc.

The information contained herein has been compiled by Keystone Retaining Wall Systems and to the best of our knowledge, accurately represents the Keystone product use in the applications which are illustrated. This drawing is being furnished for design guidance and estimating only. Final determination of the suitability for the use contemplated and its manner of use are the sole responsibility of the user. Structural and geotechnical design analysis shall be performed by a qualified engineer.

Any party accepting this document does so in confidence and agrees that it shall not be duplicated in whole or in part, nor disclosed to others without the consent of Keystone Retaining Wall Systems, Inc.

No.	Date	Revision	By



Designed By:
cdm

Checked By:

Date:
1/10/00

Specialty Applications

In-Situ Slip Joint

Project No: Drawing No. 12